



NEW FOR 2021

The Coeur d'Alene Window Company

At The Coeur d'Alene Window Company, we strive to make quality products for building and remodeling professionals that homeowners can enjoy for years to come.

Communicating the steps we are taking to produce the products you, as a building professional, need in the marketplace is part of being a good partner.



Facility Additions

New Equipment

People, Positions &
Training

6000 Series Window

6000 Series Door



Clearly Superior
Windows & Doors

115 N Sycamore St

Spokane, WA 99202

(509) 370-0705

FACILITIES

Manufacturing / 115 N Sycamore – At our main manufacturing plant, we are adding a new loading dock, three additional dock doors. We are also increasing the size of both our mainline production area and our casement/patio door line. In addition, we have installed new lighting throughout to improve defect identification and create a better work environment.



Haskins Building / Raw Materials Center – We have moved our field service and McVay Brothers overflow storage out of this facility, freeing up several thousand square feet for additional storage.



New Facility / N Dollar Road – We have relocated our lineal and squares finishing lines as well as our customer and field service units to a new facility. This facility will increase double our finishing capacity which has continued to grow at a rapid rate.



The finishing upgrade project includes the installation of two brand new filtered booths and an accelerated curing booth. The building also includes space for specials and quality control testing for our Euro-finish and Spectra Coat products.

The finishing area will be fully operational in March.

In addition, moving our customer service and field service teams has freed up considerable space at the main plant for manufacturing, engineering and human resource offices.



Kingman, AZ – The Coeur d'Alene Window Company will open up a new 90,000+ square foot manufacturing facility in Kingman, AZ during the third quarter of 2021. The facility will allow us to produce more product and transfer some of our southern business. When opened, the facility will have an equipment capacity of 400+ windows/day. The capacity will increase as additional new equipment arrives in the fourth quarter of 2021.

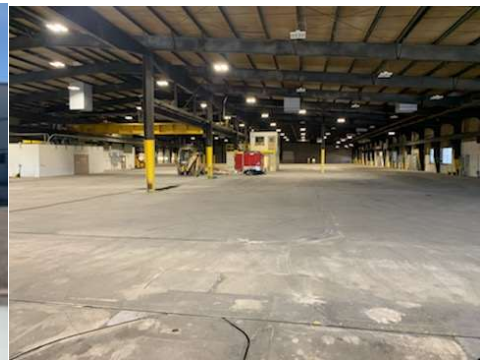

EQUIPMENT

Welding & Cleaning – We are adding both a four-point welder and a CNC corner cleaner to our main manufacturing facility in Spokane to accommodate growth.

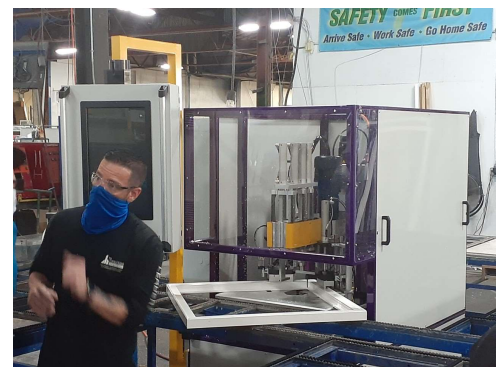

Fabrication Centers – In February, Coeur d'Alene added two Joseph fully programmable fabrication centers. This equipment combines sawing and much of the processing necessary on slider, single-hung and picture windows. With it, we are able to process our 1000, 3000 and new 6000 series windows more accurately and at greater volumes. Unlike previous versions of fabrication centers, these new state-of-the-art machines not only optimize cutting, but they are programmable so they can grow with the company as accessories, etc. are added.



Distribution – In anticipation/response to rapid growth, Coeur d'Alene has established a drop and pick route/terminal in the Portland and Salt Lake areas. In addition, we have/are added/adding three box vans, two sleeper cabs, two day cabs and multiple trailers.



PEOPLE

People – We have added some great team members recently:

Mike Miranda – Customer Service (30+ years experience)

Josh Lantz – Customer Service (10+ years experience)

Helen Chen – Customer Service

Mike Looper – National Accounts Manager

John Sweeney – Oregon Territory Manager

Zach Jensen – Programmer / Enterprise Software

Casey Sweet – Programmer / Enterprise Software

Brandie Draven – Distribution Coordinator

Mike Martin – Field Quality Control Manager (30 years experience)

We have also added experienced key employees in manufacturing, loading, material handling and accounting.

Training –

Connor McVay – Fenestration Associate (Test passed / AAMA)

Scott Green – AWDI Certified Installer

Mike Martin – AAMA Certified Installer

Steve Sweet – AAMA Certified Installer

6000 SERIES WINDOW / 6000 SERIES DOOR

6000 Series Window – We will be launching the 6000 Series Triple Glaze Window on March 1. This product is designed to support the weight of triple glazing from its unique frame design to its massive roller system. You can count on the 6000 Series to perform in the field.

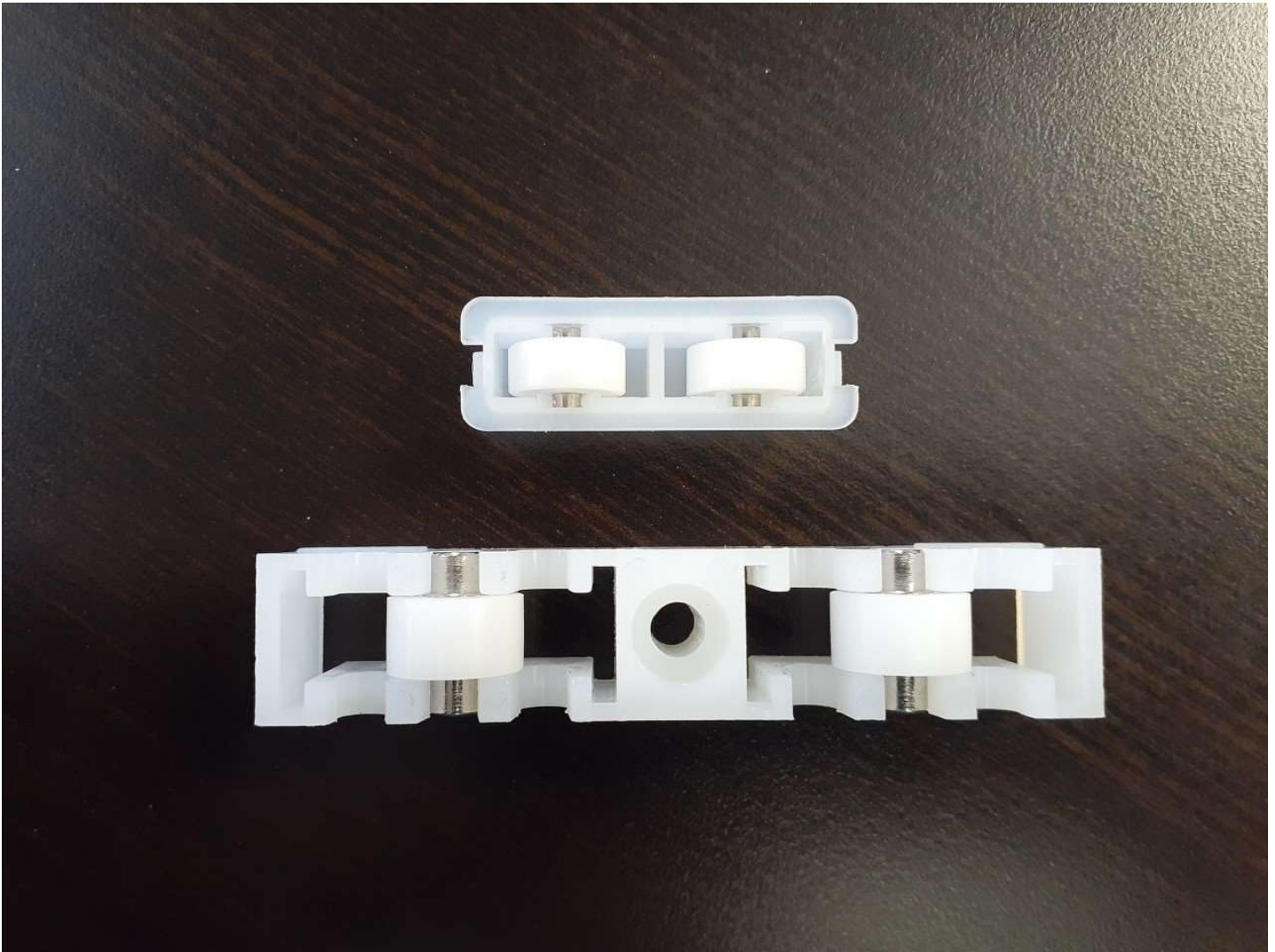

U-Value / lower = better

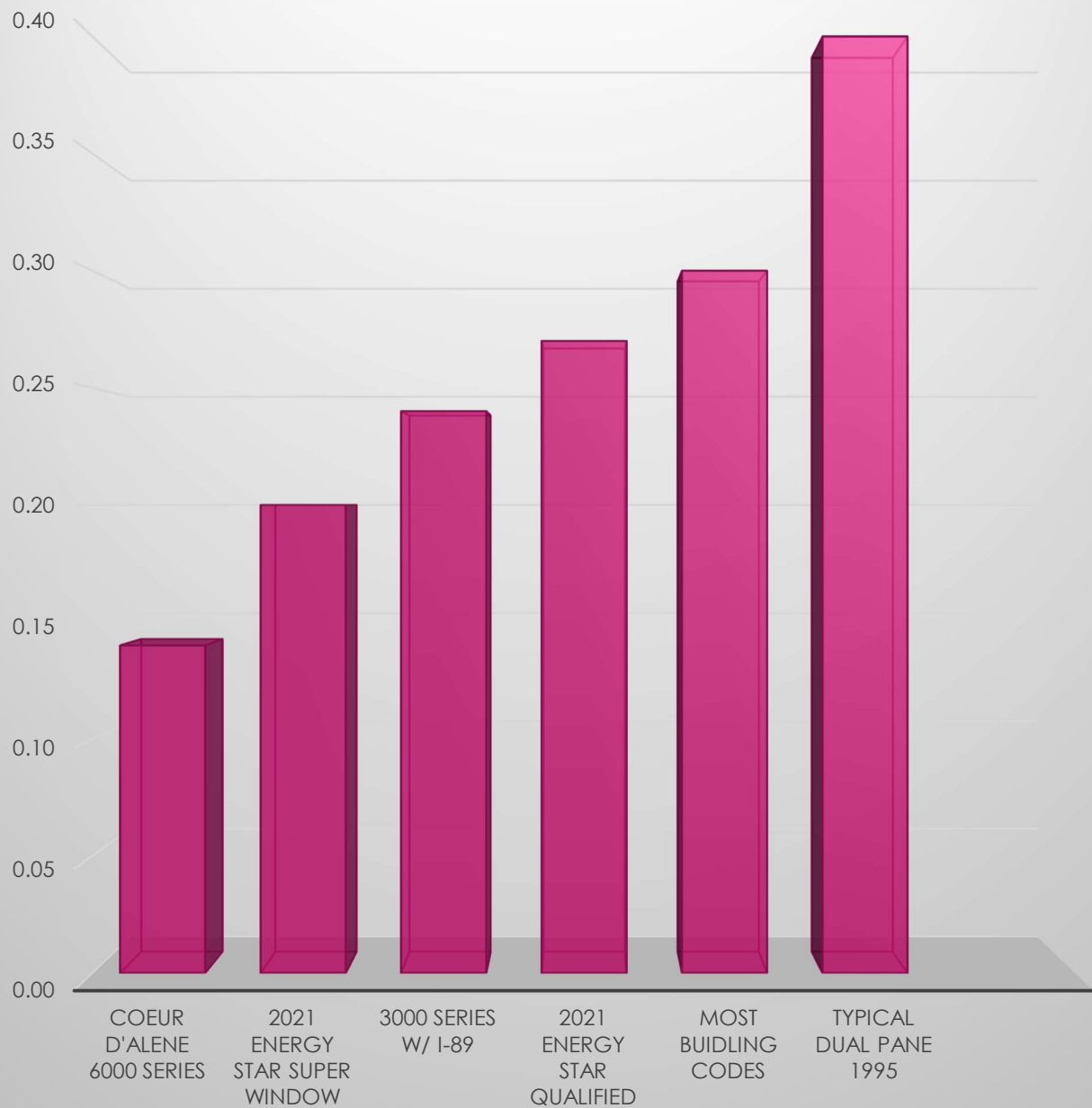

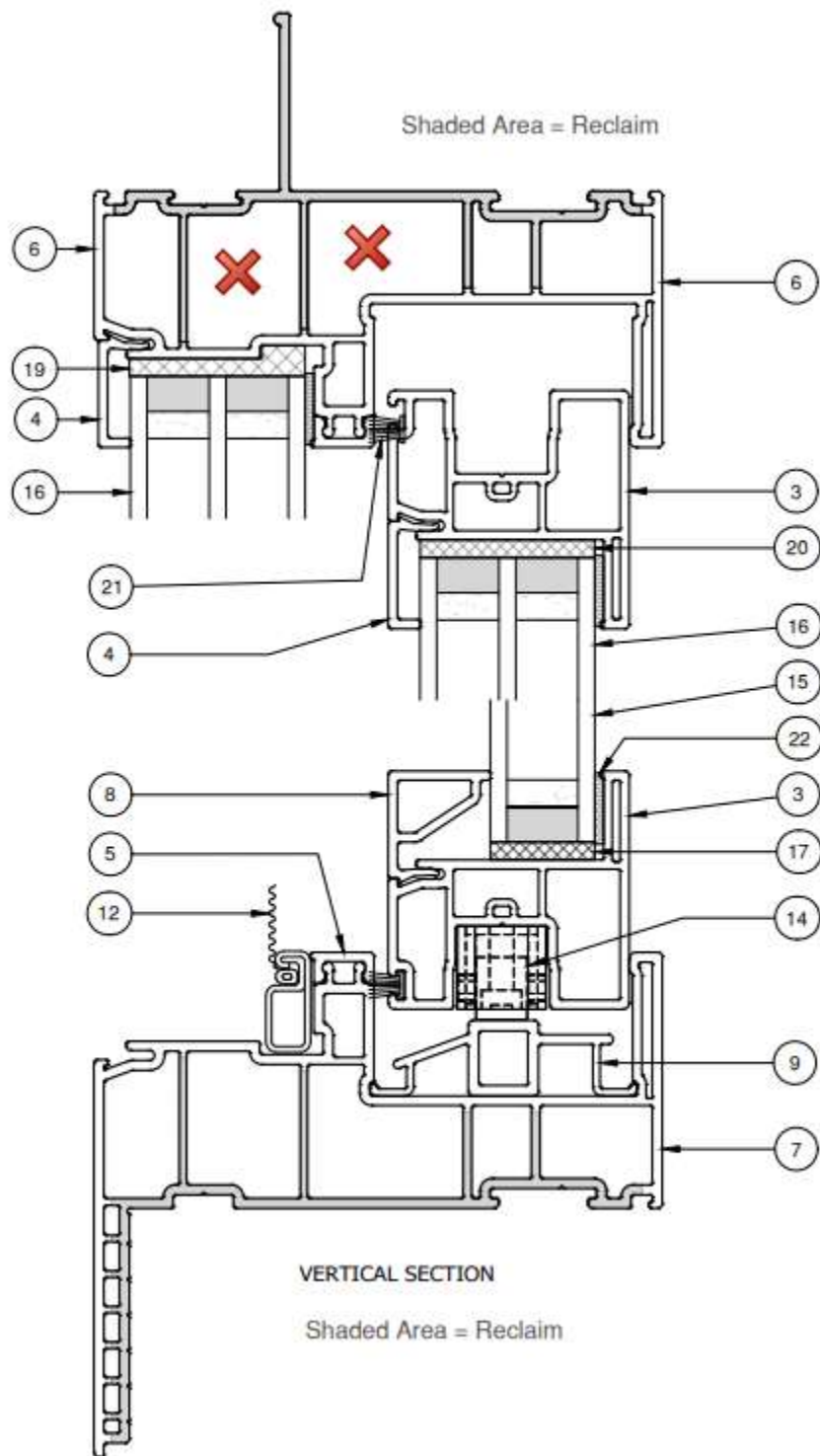



Available March 1, 2021.

6000 Series Door – The 6000 Series Door will be available in a triple slide version at launch. It will eventually be available in a quad slide version as well. The door features optional full multi-point locks and upgraded handle sets. It is a panel/panel door and will also feature an

upgraded screen (standard) and a hide-away screen for three panel + doors. The door will be available on May1.

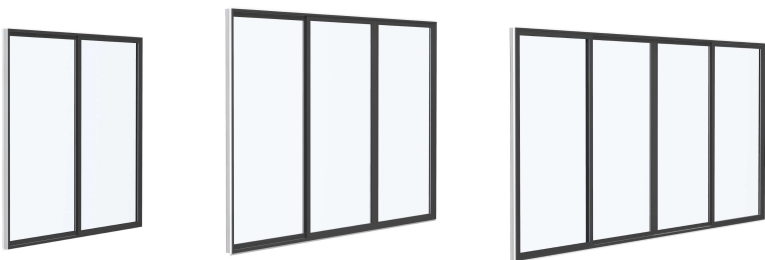



WindowDoor

Top 100 Manufacturer

EUROFINISH

CARBON™
— SERIES —

